



Dear Client,

Congratulations to your new turntable TTT-Slim II. This unit allows analogue playback on the highest level because of compact design and careful engineering in every detail. Please follow this manual carefully step by step for getting advantage of all possibilities offered by your new turntable.

Please take your time to assemble, install and adjust the turntable and tonearm carefully. Your dealer will be ready to assist you. The TTT-Slim II is a mechanical precision instrument. Please beware of using high forces or hits to this unit.

The TTT-Slim II is usually delivered including our tonearm Thales Easy. For the tonearm, please refer to its own user manual.

1) Unpacking TTT-Slim II

The packaging of this unit consists of several layers. Please open the main packaging, take out the content and place it carefully on an even base, so it is ready for installation.

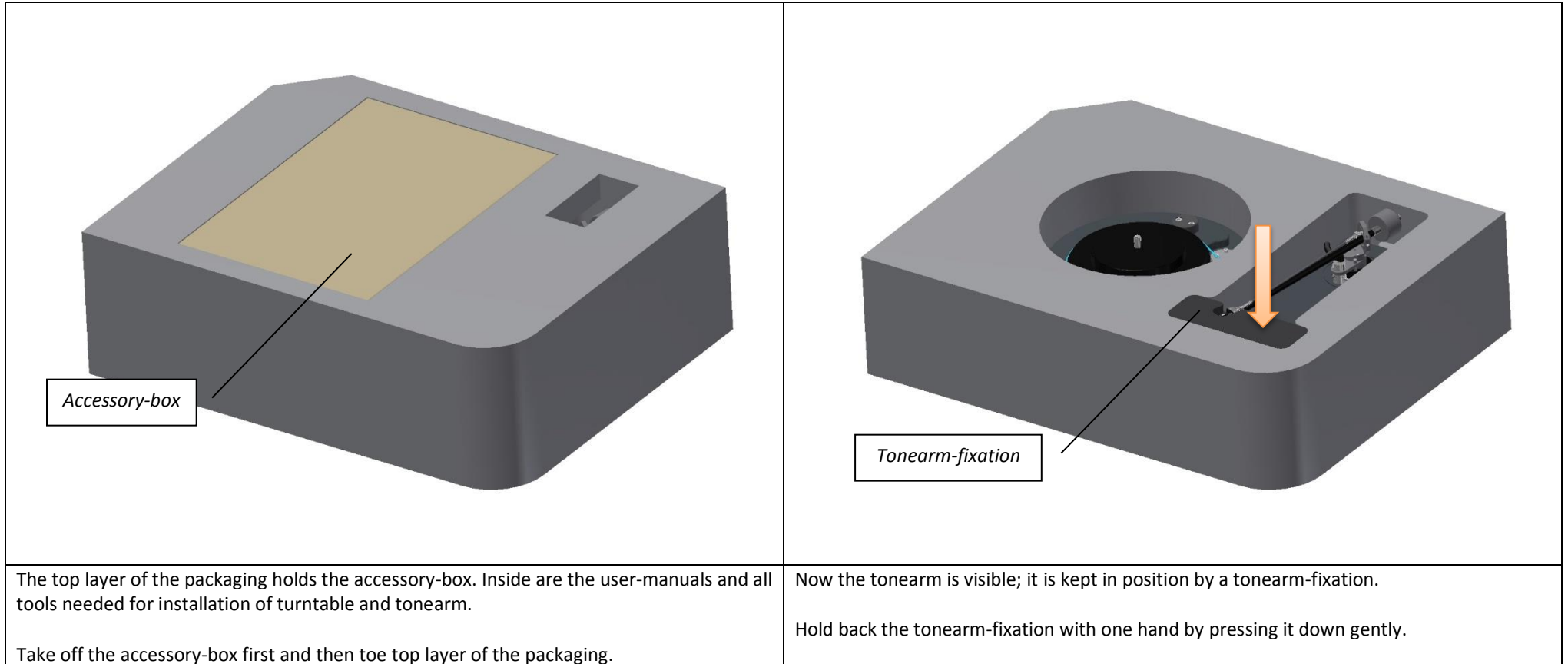

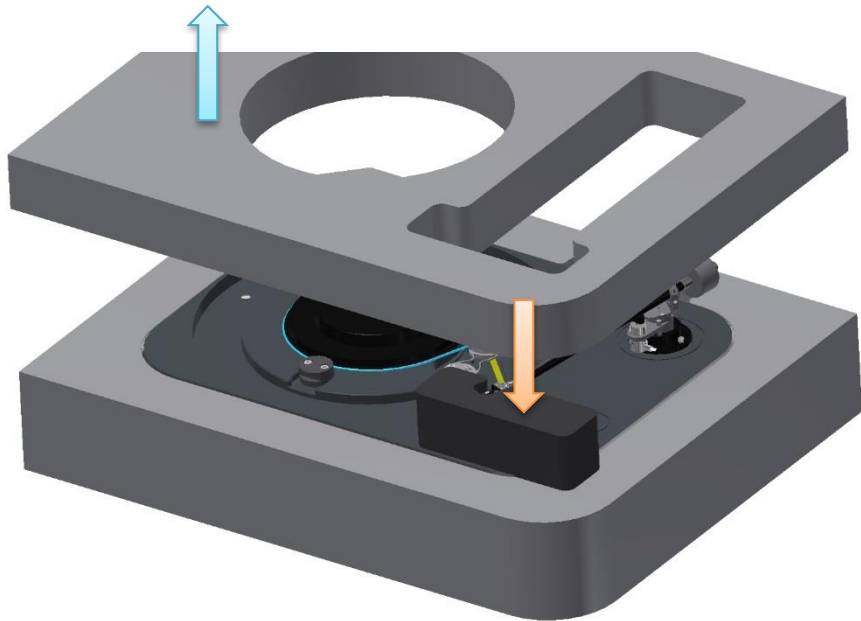

Now carefully remove the second layer of the packaging by sliding it upwards with the other hand.

Make sure the tonearm-fixation is hold in position and not removed.



Now the main chassis of the turntable is visible.

Remove the tonearm-fixation by sliding it away along the arm-tube horizontally.

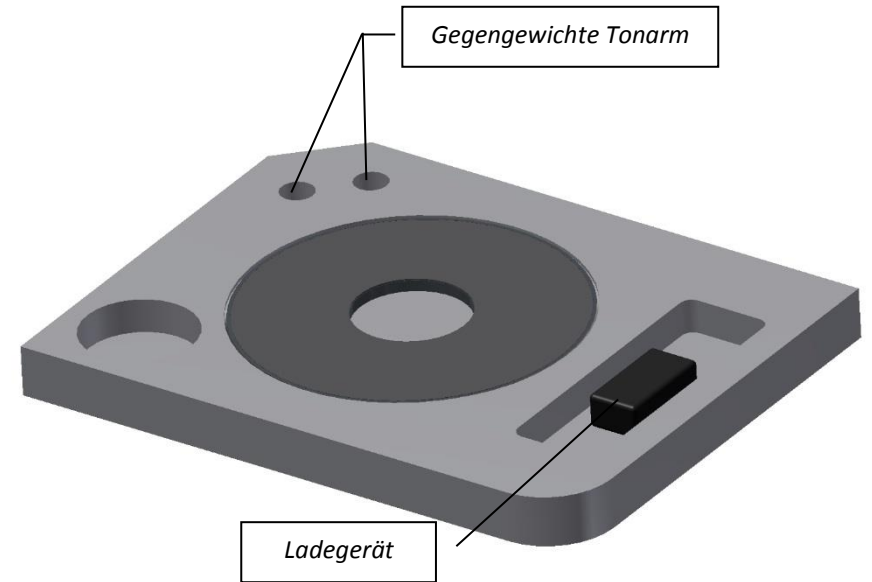

Lift up the turntable-chassis together with the tonearm. Make sure the tonearm is kept in position carefully in order to prevent it from slipping around.

Now you can remove the third packaging-layer.

Platter, charger and counter-weights are visible now. They can be taken out when needed for installation.

2) Transport-lock main bearing

The main bearing of the TTT-Compact II is locked during transport to prevent damages to the bearing caused by vibration. This locking mechanism lifts the sub-platter slightly and keeps it in position. To release the transport lock, please follow the following steps:

1. Release 4x hexagon-screw (1)
2. Remove 4x hexagon-screw (1) completely
3. Move both locking-cylinders (3) out of the sub-platter (2)
4. Turn both locking cylinders 180° around their axle
5. Reinsert 4x hexagon-screw and tighten them
6. Sub-platter incl. belt and flywheel shall be free turning now

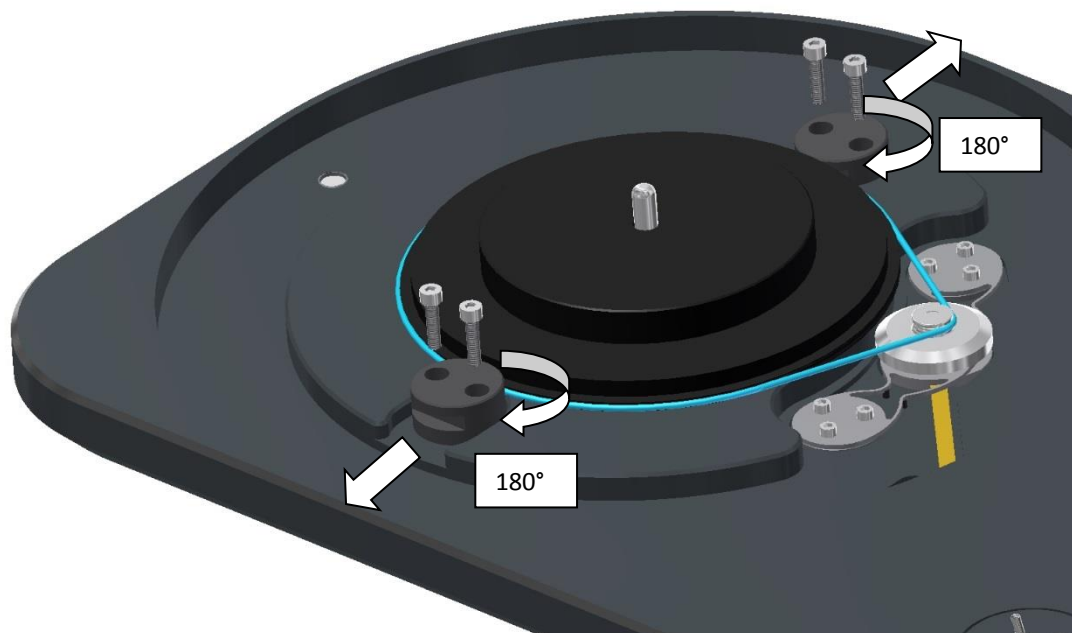
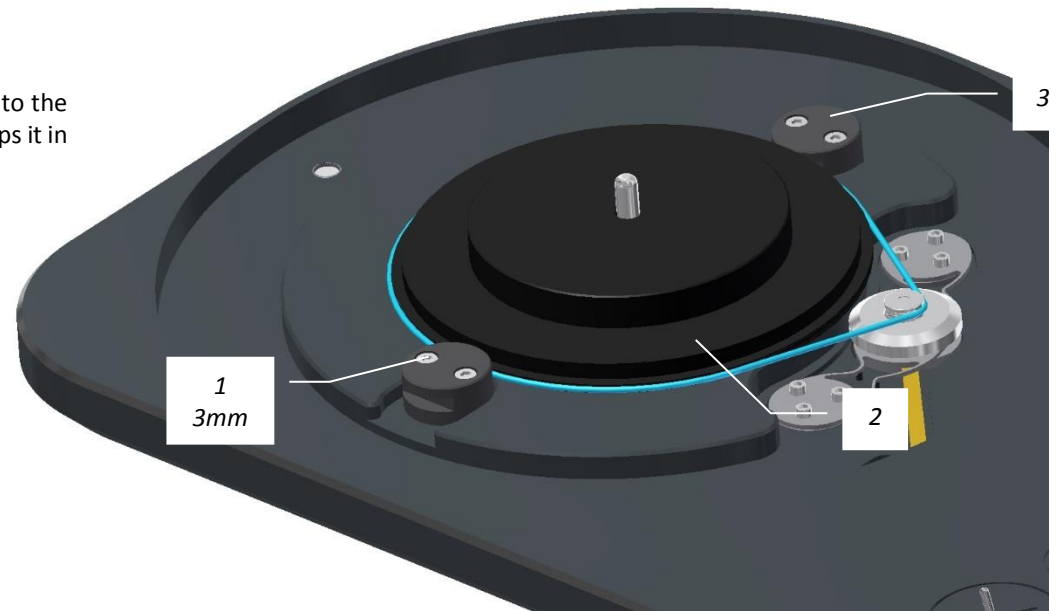

3) Installing platter

The main-platter is bearing freely on the sub-platter. During assembling, please make sure to guide the main-platter exactly vertically on the sub-platter. The main-platter has an inlay of a specified high density mat. Please take care on this mat for not destroying it during installation.

1. Guide the main platter carefully from above on the sub-platter.
2. Make sure the main -platter is bearing completely on the sub-platter.
3. If needed, dress the inlay-mat around the centre carefully, so the record will lay on an absolutely even surface.

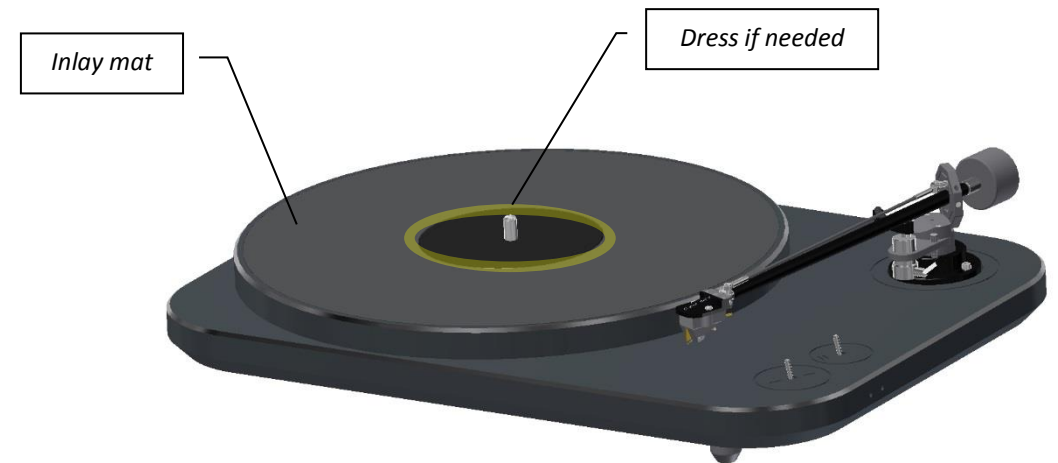
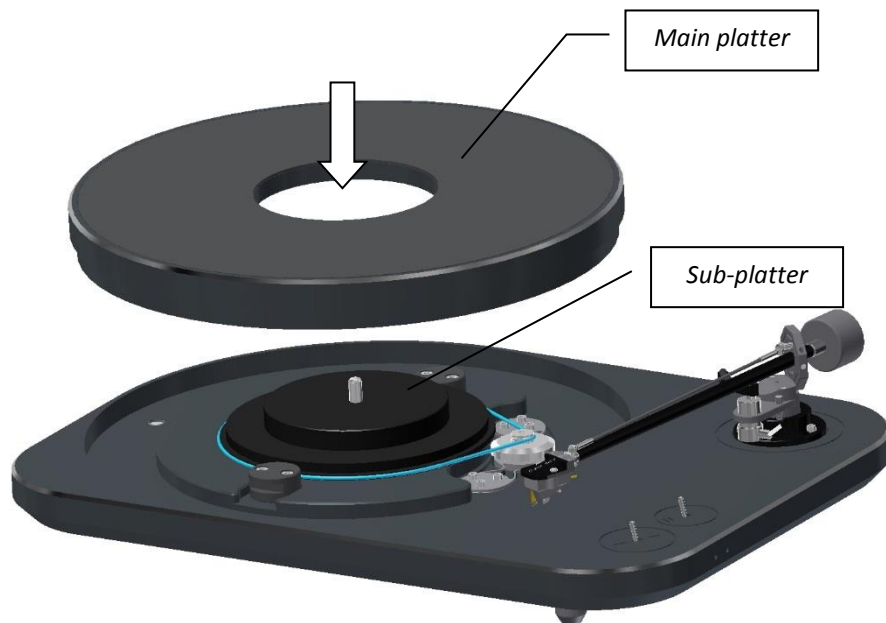

4) Installing

Tonearm

For assembling the tonearm and the cartridge, please follow the manual of the tonearm itself carefully.

Set the level

Place the unit on an even and horizontal base. The level of the TTT-Slim II can be set by turning the spikes (1) in and out of the main chassis. Please use a level gauge to level the unit exactly horizontal. Please make sure at least one of the spikes is fully tightened.

The spikes are guided not only by a fine pitch thread but by a cylindrical fitting as well. Therefore, no locking of the spike is needed. The maximum range of adjustment is 4mm.

Connection

Connect the RCA-jacks (2) with the phono-input of the preamplifier. A Thales phono-cable is available as an option.

Connect the ground-terminal (3) with the ground-socket of your preamplifier. A fitting cable is delivered with the turntable.

Connect the external charger with the power plant and with the charger-socket (4)

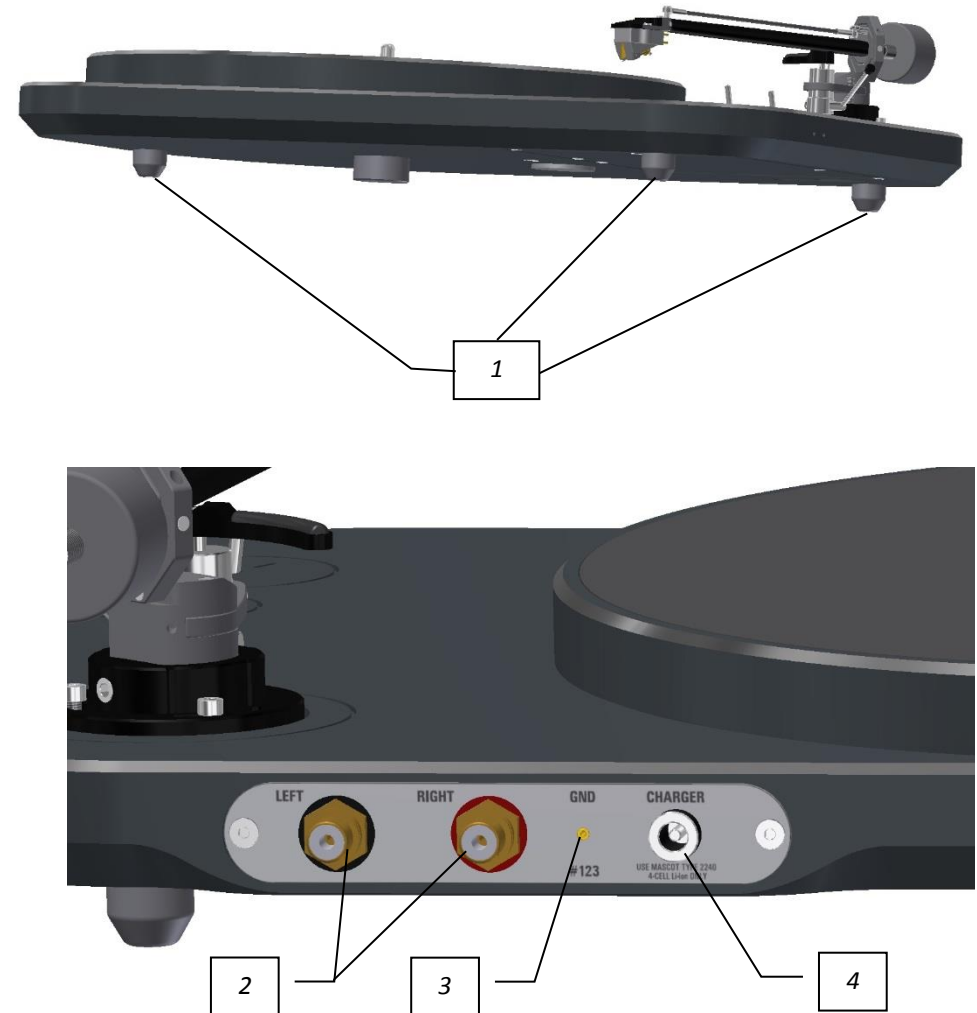

5) Internal Power Supply TTT-Slim II

The TTT-Slim II is fitted with a high-power-battery-pack. The turntable is driven by the internal power supply only. The external charger is to be used for charging the battery only. Please refer to the table on the right.

Important notes:

- A fully charged battery-pack will keep the turntable running in playback mode for at least 20 hours.
- If the unit is kept in the standby-mode (On), a small control-current is needed. Therefore, the battery will be discharged after 200 hours, even if the platter is not turning.
- We are using most modern LiMn batteries. These accumulators do have no memory-effect. This means, you are free to charge them no matter what the actual charge state is. The battery can be recharged for at least 1'000 cycles.
- The battery-pack can provide power up to 100 Watts. This energy is set free by incorrect handling of the accumulator as well. Therefore, the battery needs to be exchanged by your distributor / dealer only.
- Depending on the charge state, the external charger can produce emissions (electrical field, noise). Therefore we recommend to unplug it completely from the power-plant and turntable while playing music.
- Use the charger with the following label only:
mascot battery charger / Type 2240 4-cell Li-Ion

	Charge: If the external charger is connected, the battery will be charged. The charge state is shown on the external charger.
	Off: The unit is disconnected completely from the internal and external power-supply. The battery keeps its charge state for many months.
	On: The device is switched on, the external power supply is disconnected electrically from the circuit. The green LED shows good condition of the batteries. If the red LED starts glowing, the accumulators shall be charged within one to two hours.

6) Setting and Adjusting Speed

Use the switch (1) to start the platter turning on the depending speed. In the medium position, the device is set to the standby mode. An orange LED shows the currently active speed.

The speed of the turntable was set in our factory using most precise equipment. This setting is stable for a long time period. If re-adjusting is needed, use the screwdriver delivered with the TTT-Slim II.

The screwdriver is set thru the hole at the right side of the TTT-Slim II and connected to the internal potentiometer. Turning the key clockwise will decrease; turning it counter clockwise will increase the speed of the platter.

7) Cleaning

For cleaning the TTT-Slim II, please use a soft and clean towel. The high density inlays of the platter and the clamp shall be cleaned with a wet microfiber towel. For this process, please use water only, neither cleaning nor dissolver-liquids.



8) Specificaitons

Technical Specifications

- turntable speed: 33⅓ rpm, 45rpm
- wow and flutter at 33rpm, IEC 386: ±0,06%
- rumble: -60dB (unweighted)
- dimension (WxDxH): 423x305x100mm
- weight: 12kg
- input voltage for charger: 100-240V, 50-60Hz
- battery service life: 20h

Turntable Specificaitons

- chassis and platter made of massive aluminium
- BLDC motor underneath platter
- short-belt drive system with flywheel
- main bearing in ductile-iron body
- main shaft hardened and hand-polished
- high density mat as platter inlay
- decoupling ball element feet
- integrated drive electronics
- anthrazit anodized finish

Options

- Adapter for dif. Tonearms 9"
- Isolations-platform
- Thales Phono-cable
- Clamp with high density inlay